

"כותר ראשון חביב"
נספח ב'
למכרז פומבי מס 34/23

מערכת מידוף

אוקטובר 2023

EK A

Efrat-Kowalsky Architects
3 Levontin St. Tel-Aviv 65111
T: 972-3-5256735 F: 972-3-6295141
office@efrat-kowalsky.co.il
www.efrat-kowalsky.co.il

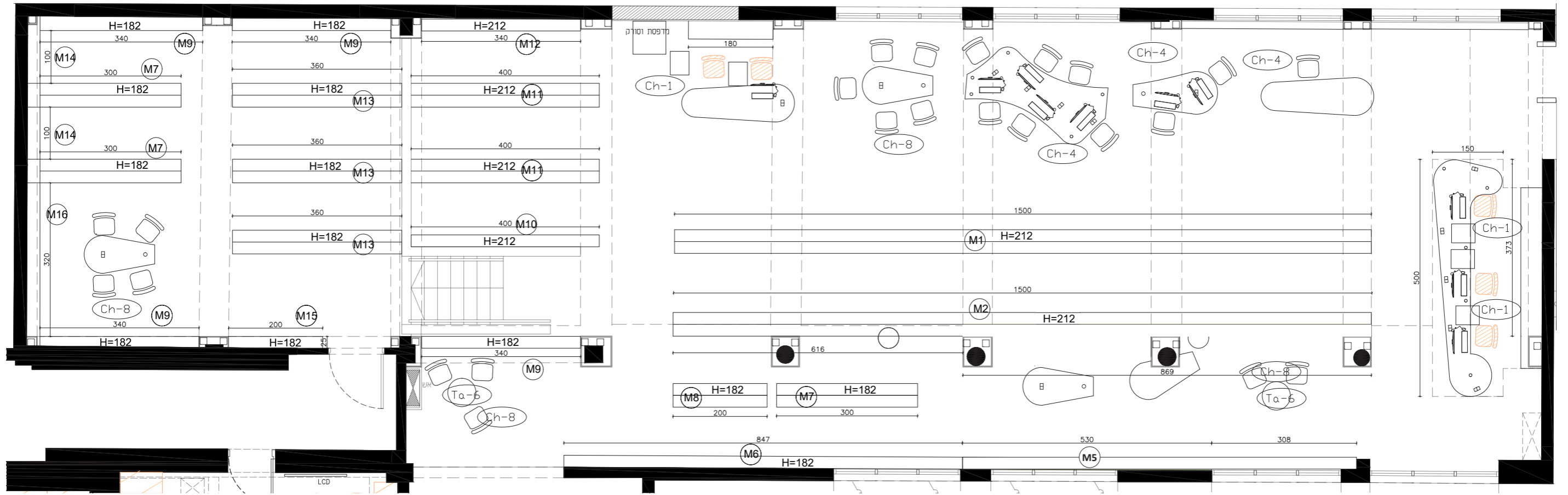

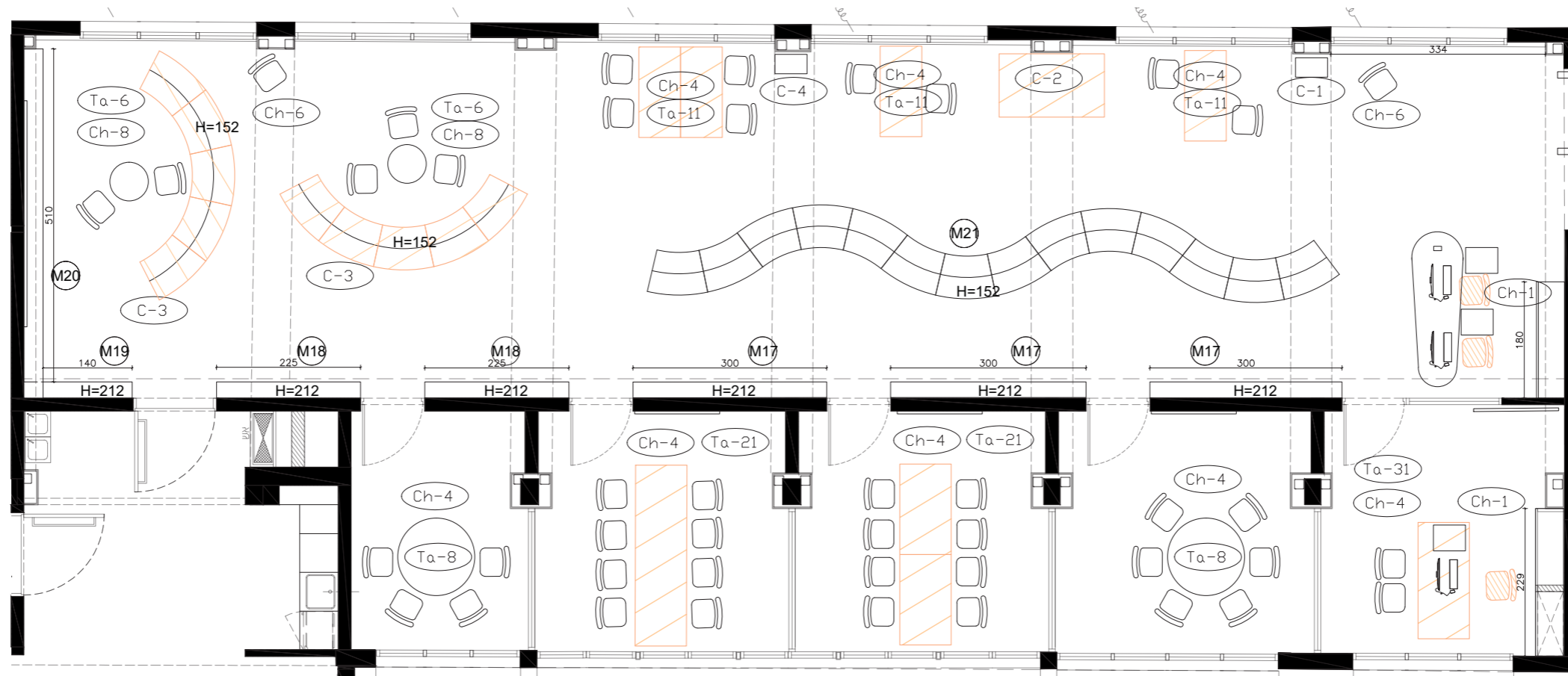

הדמיה פנים - חלל ספרייה
קומת קרקע



60/30 ROUND STEEL SHELVING

The following pages will show basic configurations of the 60/30 round steel shelving system based on 60/30 upright installations. Please find important dimensions below.

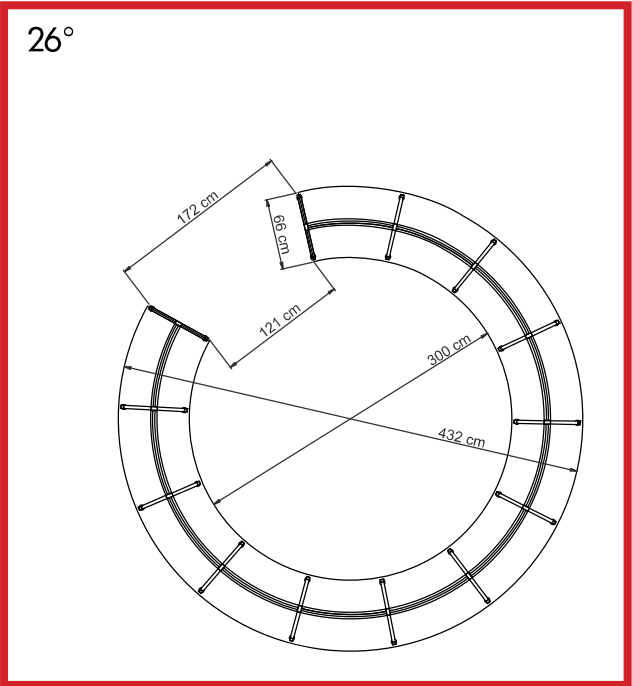
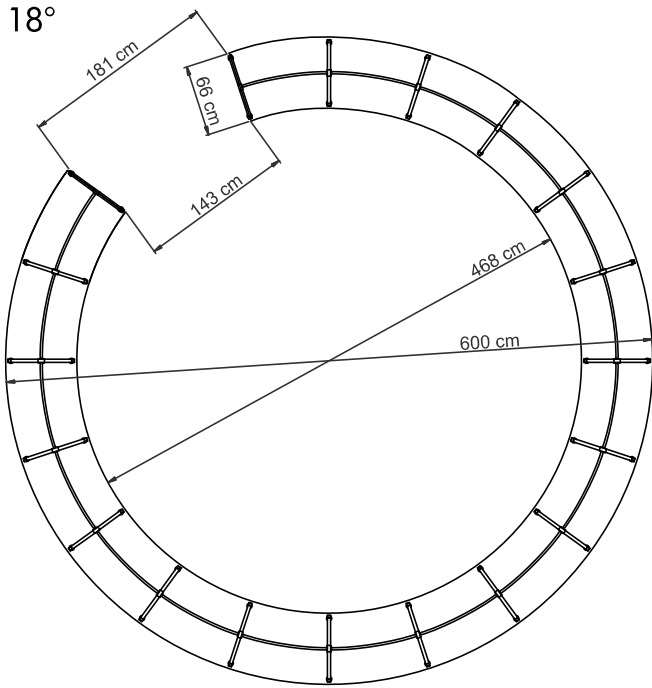

HEIGHTS

60/30 Round Steel Shelving system comes in 5 heights; 92, 122, 152, 182 and 212 cm. Heights include adjustable feet (max. 2.5 cm). The shelves are adjustable in 2.5 cm increments.

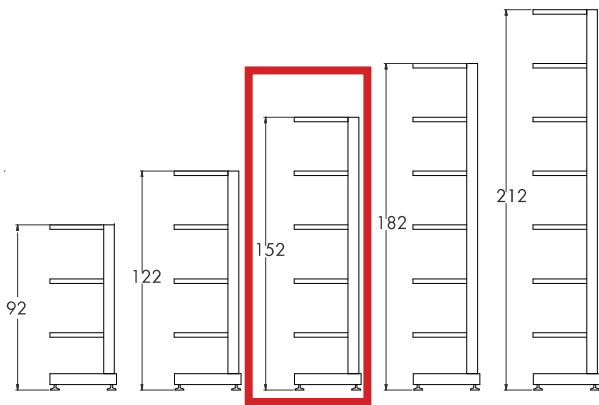

WIDTHS

The bays are available as starter and add-on bays. A starter bay has two uprights and an add-on bay has one upright.

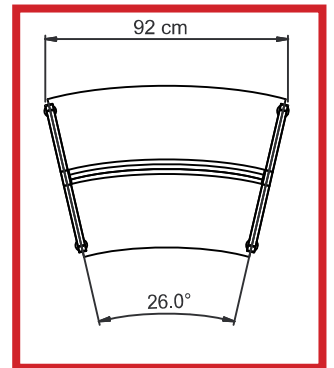
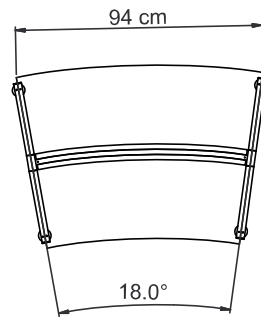

DEPTHS

The uprights come in one depth: 66 cm for 2 x 30 cm deep shelves

